

ADJUSTABLE INDICATOR POST



UL / FM

FIRE PROTECTION PRODUCTS

A-20806: Adjustable Type Indicator Post

☐ UL Listed ☐ ULC Listed ☐ FM Approved

PARTS LIST

Catalog Parts No.	Description	Material	Material Standard
P206	SHUT target	Plastic	Zytel
P209	OPEN target	Plastic	Zytel
P218	Coupling	Steel	ASTM A500 GR.B
P219	Cotter Pin (long)	Brass	ASTM B21
P242	Retaining ring	Stainless Steel	AISI 302
P244	Hex bolt (not shown)	Steel/zinc plated	ASTM A307 GR.A
P273	Bell	Cast iron	ASTM A126 CL.B
P303	Hex nut (not shown)	Steel/zinc plated	ASTM A563 GR.A
P304	Operating nut	Ductile iron	ASTM A536 GR.65-45-12
P305	Cap	Polypropylene	
P307	Spring pin	Stainless steel	AISI 420
P308	Threaded sleeve	Plastic	Zytel
P309	Upper stem	Steel	ASTM A513
P315	Pipe plug - hex socket	Steel	
P316	Post head	Cast iron	ASTM A126 CL.B
P317	Window	Plexiglass	
P322	Hex head screw	Steel/zinc plated	ASTM A307 GR.A
P323	Lower barrel	PVC	DR14 UL Listed
P324	Upper barrel	Steel	ASTM A53 GR.B
P325	Wrench	Ductile iron	ASTM A536 GR. 5-45-12
P326	Lower stem	Steel	ASTM A500 GR.B
P329	Socket head set screw	Steel	ANSI B18.3
P350	Coupling insert	Steel	ASTM A500 GR.B
P353	Washer	Stainless steel	AISI 304

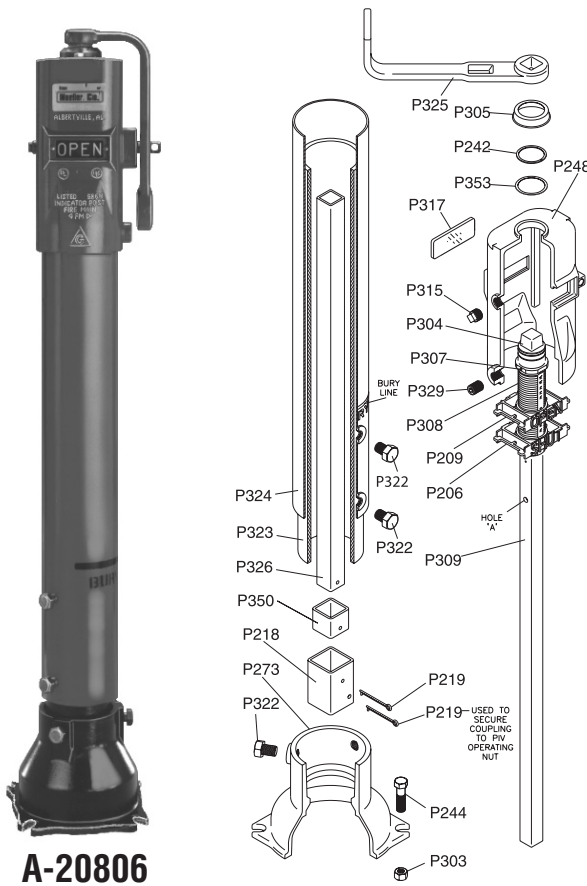

A-20806

Table 1 Valve Size	A & B DIMENSIONS FOR MUELLER METAL SEAT POST INDICATOR VALVES			A & B DIMENSIONS FOR MUELLER RESILIENT WEDGE POST INDICATOR VALVES			C DIMENSIONS FOR ALL VALVES -1/2 OF PIPE O.D. (Typical for underground pipe)
	A	B	Turns to Open	A	B	Turns to Open	
4"	-	-	-	14.31"	12.72"	14-1/2	2.40"
6"	-	-	-	18.12"	16.53"	20-1/2	3.45"
8"	-	-	-	21.25"	19.66"	27	4.53"
10"	-	-	-	26.38"	24.79"	33-1/2	5.55"
12"	-	-	-	29.50"	27.91"	39-1/2	6.60"
14"	32.12"	29.62"	46	30.75"	29.15"	43-1/2	7.65"
16"	-	-	-	35.88"	34.28"	50	8.70"

Determining Order Length

For Mueller valves and a given Trench Depth (TD), see Table 3. For all others: calculate dimension D as follows, then use it to select the "Order Length" from Table 2 that best accommodates the minimum D length.

$$D \text{ (req'd)} = TD - B - C$$

Table 2	ORDER LENGTH AS A FUNCTION OF D DIMENSION					
	A	B	C	D	E	F
Min.	17.25"	36.00"	57.00"	78.00"	99.00"	120.00"
Max.	39.25"	60.25"	81.25"	102.25"	123.25"	144.25"

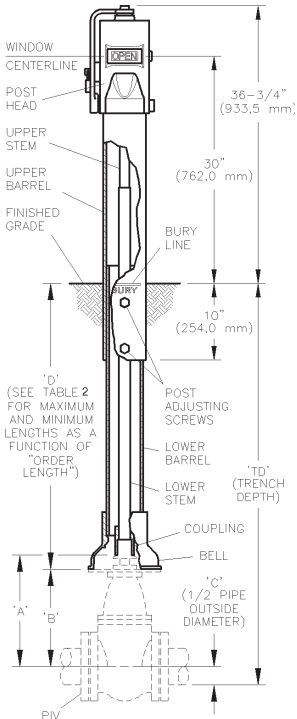

Table 3 Valve Size	NOMINAL TRENCH DEPTHS* FOR MUELLER IBFM DOUBLE DISC & RESILIENT WEDGE POST INDICATOR VALVES*											
	Order Length A		Order Length B		Order Length C		Order Length D		Order Length E		Order Length F	
	Min.	Max.	Min.	Max.	Min.	Max.	Min.	Max.	Min.	Max.	Min.	Max.
4"	2' 7"	4' 5"	4' 3"	6' 3"	6' 0"	8' 0"	7' 8"	9' 8"	9' 5"	11' 5"	11' 3"	13' 3"
6"	3' 1"	4' 9"	4' 7"	6' 7"	6' 4"	8' 4"	8' 2"	10' 2"	9' 9"	11' 9"	11' 7"	13' 7"
8"	3' 6"	5' 3"	5' 0"	7' 0"	6' 8"	8' 8"	8' 5"	10' 5"	10' 3"	12' 3"	12' 0"	14' 0"
10"	3' 11"	5' 8"	5' 5"	7' 5"	7' 3"	9' 3"	9' 0"	11' 0"	10' 8"	12' 8"	12' 5"	14' 5"
12"	4' 4"	6' 1"	5' 9"	7' 9"	7' 6"	9' 6"	9' 4"	11' 4"	11' 1"	13' 1"	12' 9"	14' 9"
14"	4' 6"	6' 3"	6' 1"	8' 1"	7' 8"	9' 8"	9' 6"	11' 6"	11' 3"	13' 3"	13' 1"	15' 1"
16"	5' 0"	6' 9"	6' 6"	8' 6"	8' 3"	10' 4"	10' 1"	12' 1"	11' 8"	13' 9"	13' 6"	15' 6"

* The minimum and maximum trench depths which will be accommodated by specific "Order Length" can be calculated as follows by using the minimum and maximum D dimensions given in Table 2. TD (min.) = D (min.) + B + C. TD (max.) = D (max.) + B + C.