

# 2-1/2"-12 SPRING ASSISTED CUSHIONED SWING CHECK VALVES WITH FL. X FL.

Rev. 2-09 Shaded area indicates change.

- ❑ Catalog number---
  - A-2604-6-02 flanged ends, with bronze disc facing
  - A-2606-6-02 flanged ends, with rubber disc facing
- ❑ Sizes---2-1/2", 3", 4", 6", 8", 10", 12"
- ❑ Meets all applicable parts of ANSI/AWWA C508 Standard
- ❑ Weight and lever design with adjustable pneumatic cylinder to control opening and closing speed of clapper
- ❑ Flanged end dimensions and drilling comply with ANSI B16.1, class 125
- ❑ Iron body, bronze mounted (IBBM)
- ❑ Choice of bronze or rubber disc facing
- ❑ For vertical or horizontal installation
- ❑ O-ring sealed stuffing box
- ❑ 175 psig (1207 kPa) maximum working pressure, 350 psig (2414 kPa) test pressure

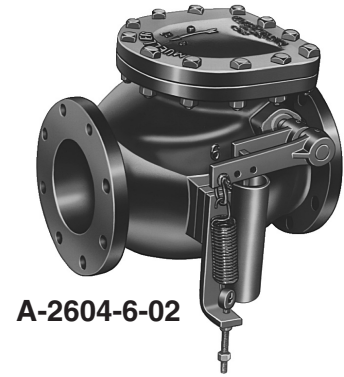

A-2604-6-02

**Options**

- ❑ Epoxy Coating    ❑ PN 10/PN 16 Flange Drilling 4"-12"    ❑ Tapped Bosses
- ❑ Stainless Steel Nuts & Bolts

**Check Valve Parts (1959-present)**

Catalog Part No.	Description	Material	Material Standard
CU-41	Cover	Cast Iron	ASTM A126 CL.B
CU-42	Cover Gasket	Cloth Inserted Rubber	ASTM D2000
CU-43	Cover Bolt and Nut	Steel	ANSI B18.2.1
CU-44	Test Plug	Steel	ASTM A307
CU-58	Seat Ring	Bronze	ASTM B584
CU-69	Roll Pin	Steel	ANSI B18.8.2
CU-71	Set Screw	Stainless Steel	ASTM A193
CU-72	Shackle	Forged Steel	
CU-73	Spring	Steel	ASTM A227
CU-74	Eye Bolt and Nut	Steel	ASTM A307
CU-75	Spring Bracket	Steel	ASTM A107
CU-76	Spring Bracket Cap Screw	Steel	ASTM A307
CU-84	Body	Cast Iron	ASTM A126 CL.B
CU-86	Stuffing Box	Bronze	ASTM B126
CU-88	Clampper Arm	Bronze	ASTM B584
CU-91	Hinge Pin	Stainless Steel	ASTM A276
CU-92	Spring lever	Steel	ASTM A36
CU-93	Jam Nut	Stainless Steel	ASTM A194
CU-94	Hinge Pin O-ring	Rubber	ASTM D2000
CU-95	Body O-ring	Rubber	ASTM D2000
CU-101	Hinge Pin	Stainless Steel	ASTM A276 Type 303
CU-102	Hinge Pin O-ring (small)	Rubber	ASTM D2000
CU-103	Hinge Pin O-ring (large)	Rubber	ASTM D2000
CU-105	Stuffing Box O-ring	Rubber	ASTM D2000
CU-106	Stuffing Box	Bronze	ASTM B138
CU-206	Cylinder assembly		
CU-207	Cap Screw	Steel	ANSI B18.2.1
CU-209	Spacer	Steel	
<b>Metal Faced Disc Parts</b>			
CU-48	Stud Nut	Bronze	ASTM B62
CU-49	Disc Stud	Bronze	ASTM B21
CU-53	Disc*	Cast Iron	ASTM A126 CL.B
<b>Rubber Faced Disc Parts</b>			
CU-50	Disc Stud	Bronze	ASTM B21
CU-54	Disc**	Cast Iron	ASTM A126 CL.B
CU-55	Rubber Disc Facing	Rubber	ASTM D2000
CU-56	Retainer Washer	Bronze	ASTM B584
CU-57	Retainer Nut	Bronze	ASTM B62

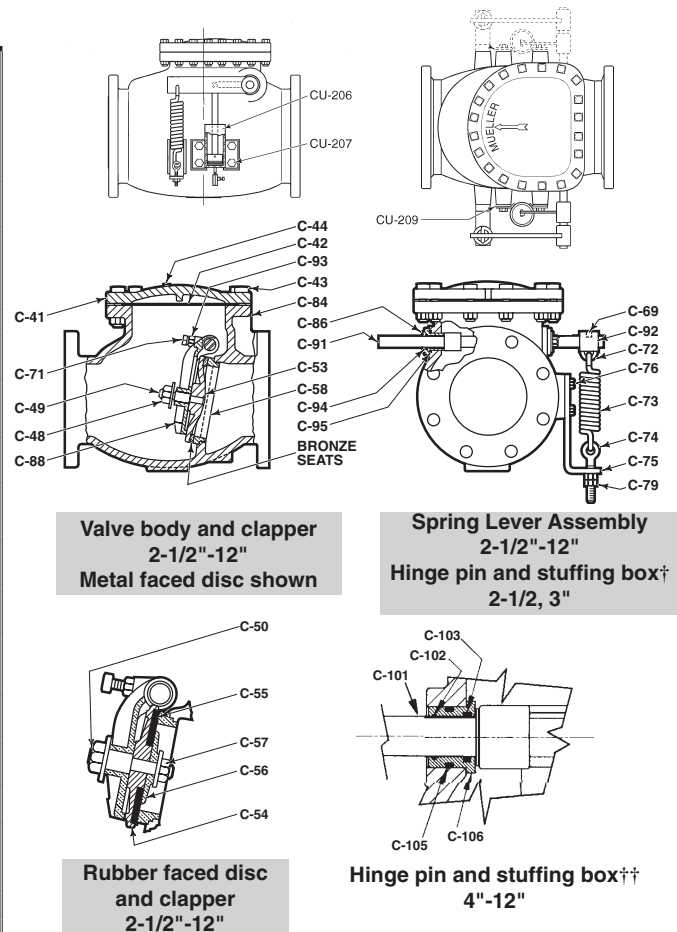

\*2-1/2" and 3" sizes are bronze, ASTM B584. Sizes 4" and larger with cast iron disc have bronze on seating area.

\*\*2-1/2"-4" sizes are bronze ASTM B584.

†Illustration for 1993 through current 2-1/2" and 3" sizes; also applies to all 2-1/2" through 12" sizes 1959 through 1992.

††Illustration for 1993 through current 4" through 12" sizes only. Parts are not interchangeable with 1992 and prior sizes. For 1959 through 1992 valves, see footnote †, above. Contact Mueller for valves 1958 and prior.

‡2-1/2" thru 12" steel ASTM A108, 4" and 6" ductile iron ASTM A536