

**N.R.S. RESILIENT WEDGE  
TAPPING VALVES**



**UL / FM**

**FIRE PROTECTION PRODUCTS**

**I-USP0-16**

Flanged x Mechanical Joint Ends  
Indicator Post Style Stuffing box  
2" Square Operating Nut  
**With Mechanical Joint accessories\***

- 4", 6", 8", 10" and 12" sizes
- Meets or exceeds all applicable requirements of UL 262 and FM 120/1130 specifications and complies with NSF-61
- Iron body Fusion epoxy coated interior & exterior surfaces
- Non-rising bronze stem

**I-USP0-19**

Flanged x Mechanical Joint Ends  
Indicator Post Style Stuffing box  
2" Square Operating Nut  
**Less Mechanical Joint accessories**

- Rubber encapsulated iron wedge
- 200 psig (1379 kPa) maximum working pressure, 400 psig (2758 kPa) static test
- Triple O-ring seal stuffing box (2 Upper & 1 lower O-rings)
- Epoxy coating meets or exceeds ANSI/AWWA C550 and complies with NSF-61



**I-USP0-19**

(Shown less accessories)

**Options**

- Position indicators
- Stainless steel fasteners: Type 304 or 316
- ASTM B98-C66100/H02 stem

**PARTS LIST**

Catalog Part No.	Description	Material	Material Standard
G-16	Bonnet Bolts & Nuts	Stainless Steel	Type 307
G-27	Wrench Nut	Cast Iron	ASTM A126 CL.B
G-41	Stuffing Box Bolts & Nuts	Stainless Steel	Type 307
G-49	Stem O-rings (3)	Rubber	ASTM D2000
G-79	Inlet Flange Gasket	Rubber	ASTM D2000
G-80	Inlet Flange Bolts & Nuts	Carbon Steel	ASTM A307 Grade B, Zinc Plated
G-152	Stuffing Box	Cast Iron	ASTM A126 CL.B
G-200	Wrench Nut Cap Screw	Stainless Steel	Type 307
G-201	Stuffing Box Seal	Rubber	ASTM D2000
G-203	Stem	Bronze	ASTM B138
G-205	Stem Unit	Bronze	ASTM B62
G-206	Guide Cap Bearings	Thermal Plastic	
G-208	Anti-friction Washers (2)	Thermal Plastic	
G-209	Wedge, Rubber Encapsulated	Cast Iron**	ASTM A126 CL.B
G-210	Bonnet	Cast Iron	ASTM A126 CL.B
G-211	Bonnet Gasket	Rubber	ASTM D2000
G-212	Body	Cast Iron	ASTM A126 CL.B

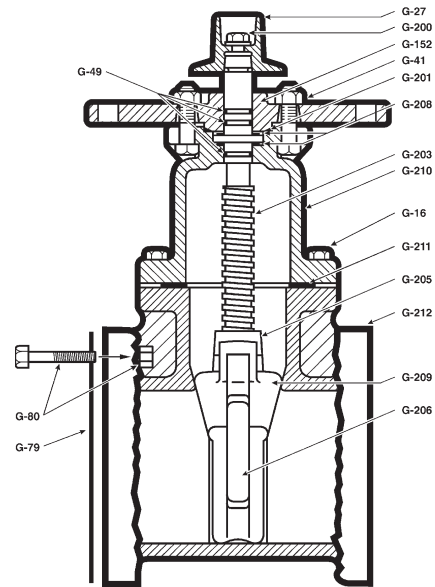

**DIMENSIONS**

Dimension*	Size				
	4"	6"	8"	10"	12"
A	14.19"	18.00"	21.50"	25.50"	28.62"
C	9.00"	11.00"	13.50"	16.00"	19.00"
D	5.00"	7.00"	9.00"	11.00"	13.00"
E	0.18"	0.25"	0.25"	0.25"	0.25"
F	6.24"	6.75"	7.50"	8.44"	8.26"
J	4.80"	6.90"	9.05"	11.10"	13.20"
K	9.12"	11.12"	13.38"	15.68"	17.94"
O (number and size of holes for FL)	8--.75"	8--.88"	8--.88"	12--1"	12--1"
FF	4.30"	6.30"	8.30"	10.30"	12.30"
YY	11.91"	13.00"	14.75"	15.80"	16.26"
FFF (number and size of holes for MJ)	4--.88"	6--.88"	6--.88"	8--.88"	8--.88"
Turns to open	14	20.5	26.5	33	38.5
Weight (lbs.)*	127	183	280	422	557

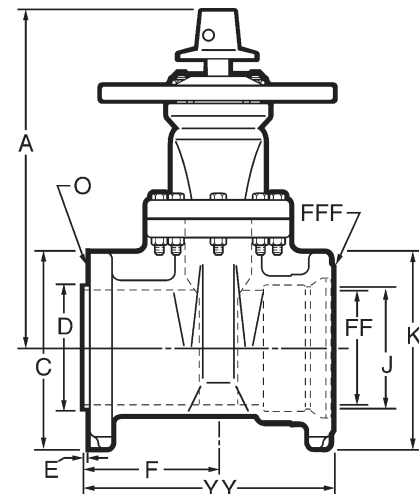

NOTE: Flanged ends have 125 lb. American Standard End Flange Drilling, ANSI B16.1.

See page B-11 for ordering instructions.

+ MJ accessories are included and palletized separately from valves.

\*All dimensions are in inches. All weights are in approximate pounds.

\*\* Fully encapsulated in molded rubber with no iron exposed.