

No.	DESCRIPTION	MATERIAL DESCRIPTION
1	BODY	CAST LOW LEAD BRASS ALLOY
2	CAP	CAST BRASS ASTM B62 ALLOY C83600
3	STEM	LOW LEAD BRASS ALLOY
4	BALL	LOW LEAD BRASS ALLOY
5	GASKET	NITRILE ASTM D2000
6	SOLID PIN	AISI 304 ANNEALED STAINLESS STEEL
7	O-RING	EP ASTM D2000
8	END PIECE	CAST LOW LEAD BRASS ALLOY
9	O-RING	EP ASTM D2000
10	HANDLE	CAST BRASS ASTM B62 ALLOY C83600
11	SCREW	AISI 304 STAINLESS STEEL
12	LOCKNUT	TYPE 18-8 STAINLESS STEEL

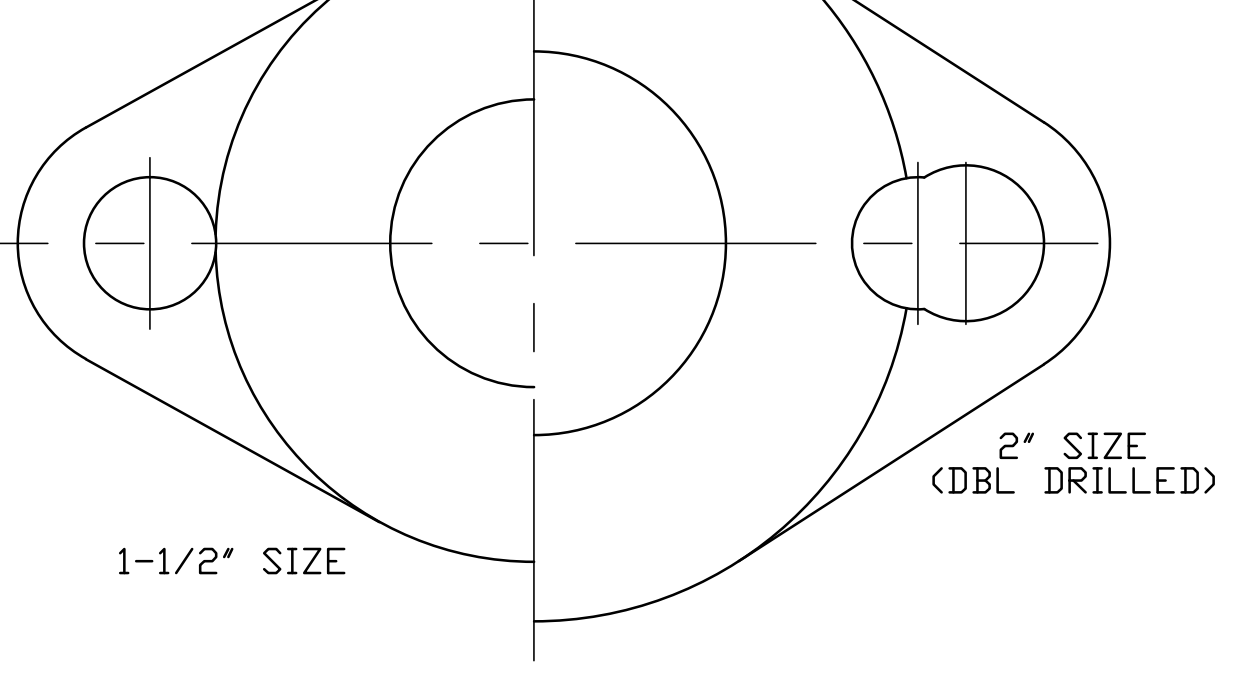

ALL WETTED PARTS ARE LOW LEAD BRASS ALLOY

VALVE SIZE	A	NPT SIZE
1-1/2"	4-61/64"	1-1/2"
2"	5-49/64"	2"

FILEPATH: PROD-ENG\JJ\SUBMITTALS\E1913FJ

DRFTR	RWB	2/4/10	<b>JONES</b>
CHKR			
ENGR			
MGR			
UNLESS OTHERWISE NOTED			THIRD ANGLE PROJECTION
SURFACE PREPARATION:			
BREAK CORNER(S) ---- .000			
SURFACE FINISH -- XX RMS			REF. No.
TOLERANCE(S):			SCALE
LINEAR ----- ± .000			
ANGULAR ----- ± 0°00'			
BY DATE			
STK No:			
MAT'L:			
DESCR.			
BALL STRAIGHT LLB METER VALVE			DWG NUMBER
w/ HANDLE (FIP x METER FLANGE)			E1913FJ
REV	ECR	DESCRIPTION	DATE

DWG NUMBER  
E1913FJ  
JJ-MRKTNG

TITLE TO AND OWNERSHIP OF THIS ENGINEERING DATA REMAINS IN Mueller Co. NO USE IS TO BE MADE OF THIS DATA EXCEPT AS SPECIFICALLY AUTHORIZED BY Mueller Co. ASSENT ON THE PART OF THE RECIPIENT TO THESE CONDITIONS IS PRESUMED