

ITEM	REQ'D	DESCRIPTION	MATERIAL
1	1	BODY	CAST LOW LEAD BRASS ALLOY
2	1	CAP	CAST BRASS ASTM B62 ALLOY C38600
3	1	STEM	CAST LOW LEAD BRASS ALLOY
4	1	BALL	CAST LOW LEAD BRASS ALLOY
5	2	GASKET	RUBBER D-2000 NITRILE (BUNA-N)
6	1	SPIROIL PIN	ST. STEEL A-240 TYPE 304
7	2	O-RING	RUBBER D-2000 CODE R-80
8	1	END PIECE	CAST LOW LEAD BRASS ALLOY
9	1	METER NUT	CAST BRASS ASTM B62 ALLOY C38600
10	1	SNAP RING	COPPER ALLOY CDA521
11	1	RUBBER GASKET	RUBBER D-2000 CODE R-9
12	1	CAP PLUG	PLASTIC RED POLYETHYLENE
13	1	COPPER TUBE NUT	CAST BRASS ASTM B62 ALLOY C38600

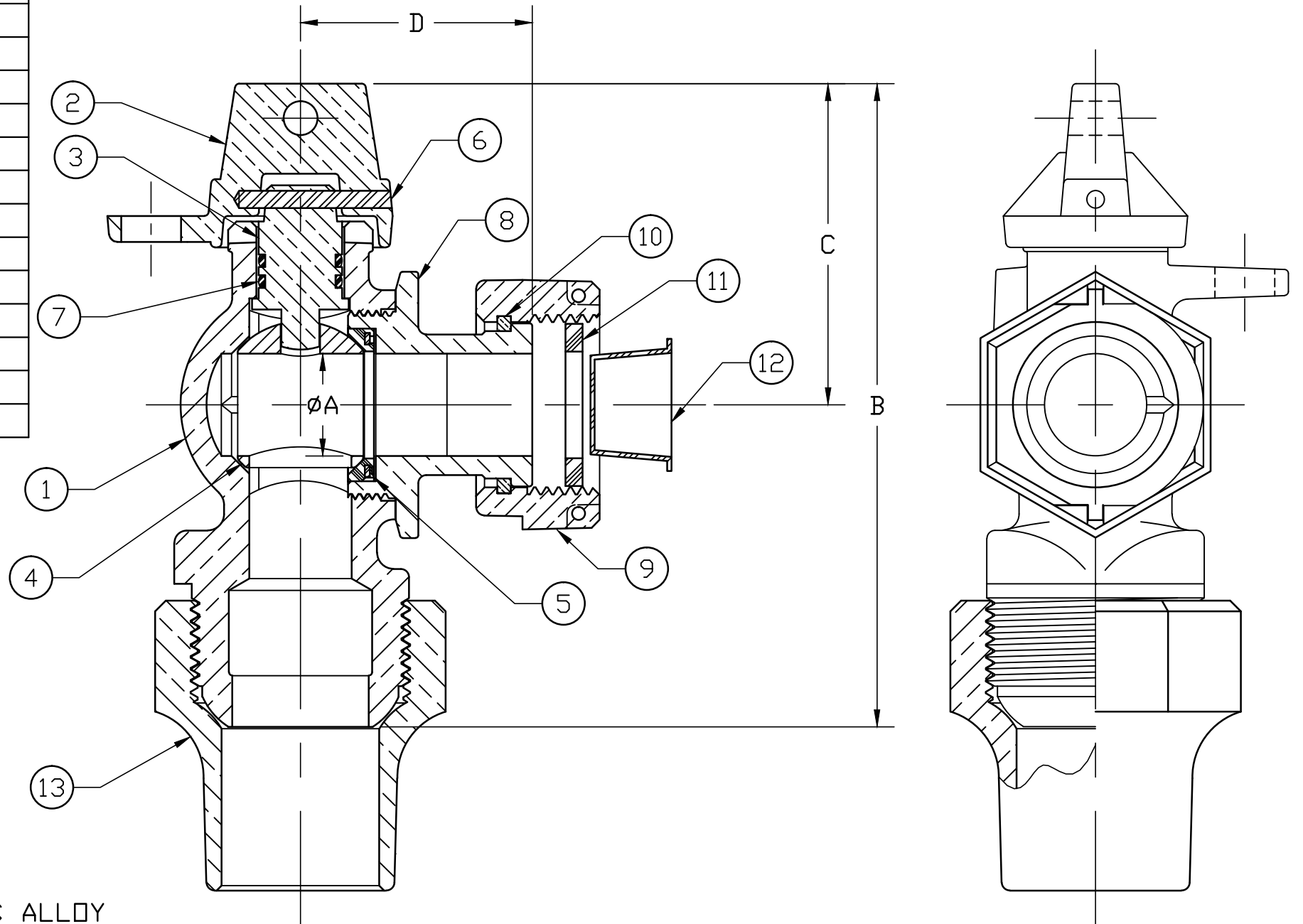

SIZE	ØA	B	C	D
5/8" x 3/4"	.75	4.33	2.35	1.69
5/8" x 3/4" x 3/4"	.75	4.33	2.35	1.69
5/8" x 3/4" x 1"	.75	4.71	2.35	1.69
1"	1.00	5.00	2.64	1.95

ALL WETTED PARTS ARE LOW LEAD BRASS ALLOY

FILEPATH: PROD-ENG\JJ\SUBMITTALS\E1964W

DRFTR	RWB	11/12/09	JONES		
CHKR					
ENGR					
MGR					
			UNLESS OTHERWISE NOTED	THIRD ANGLE PROJECTION	
			SURFACE PREPARATION:		
			BREAK CORNER(S) ---- .000		
			SURFACE FINISH -- 000 RMS	REF. No.	
			TOLERANCE(S):	SCALE	
			LINEAR ----- ± .000	NONE	
			ANGULAR ----- ± 0°00'		
			STK No:		
			MAT'L:		
			DESCR.		
			LLB ANGLE METER VALVE	DWG NUMBER	
			CS x METER	E1964W	
REV	ECR	DESCRIPTION	DATE	BY	CHKR
PER EST NO: DXXXX EST FIN WT = 0.0000 lbs					

DWG NUMBER
E1964W
JJ-MRK TG

TITLE TO AND OWNERSHIP OF THIS ENGINEERING DATA REMAINS IN Mueller Co. NO USE IS TO BE MADE OF THIS DATA EXCEPT AS SPECIFICALLY AUTHORIZED BY Mueller Co. ASSENT ON THE PART OF THE RECIPIENT TO THESE CONDITIONS IS PRESUMED