

TITLE TO AND OWNERSHIP OF THIS ENGINEERING DATA REMAINS IN Mueller Co. NO USE IS TO BE MADE OF THIS DATA EXCEPT AS SPECIFICALLY AUTHORIZED BY Mueller Co. ASSENT ON THE PART OF THE RECIPIENT TO THESE CONDITIONS IS PRESUMED

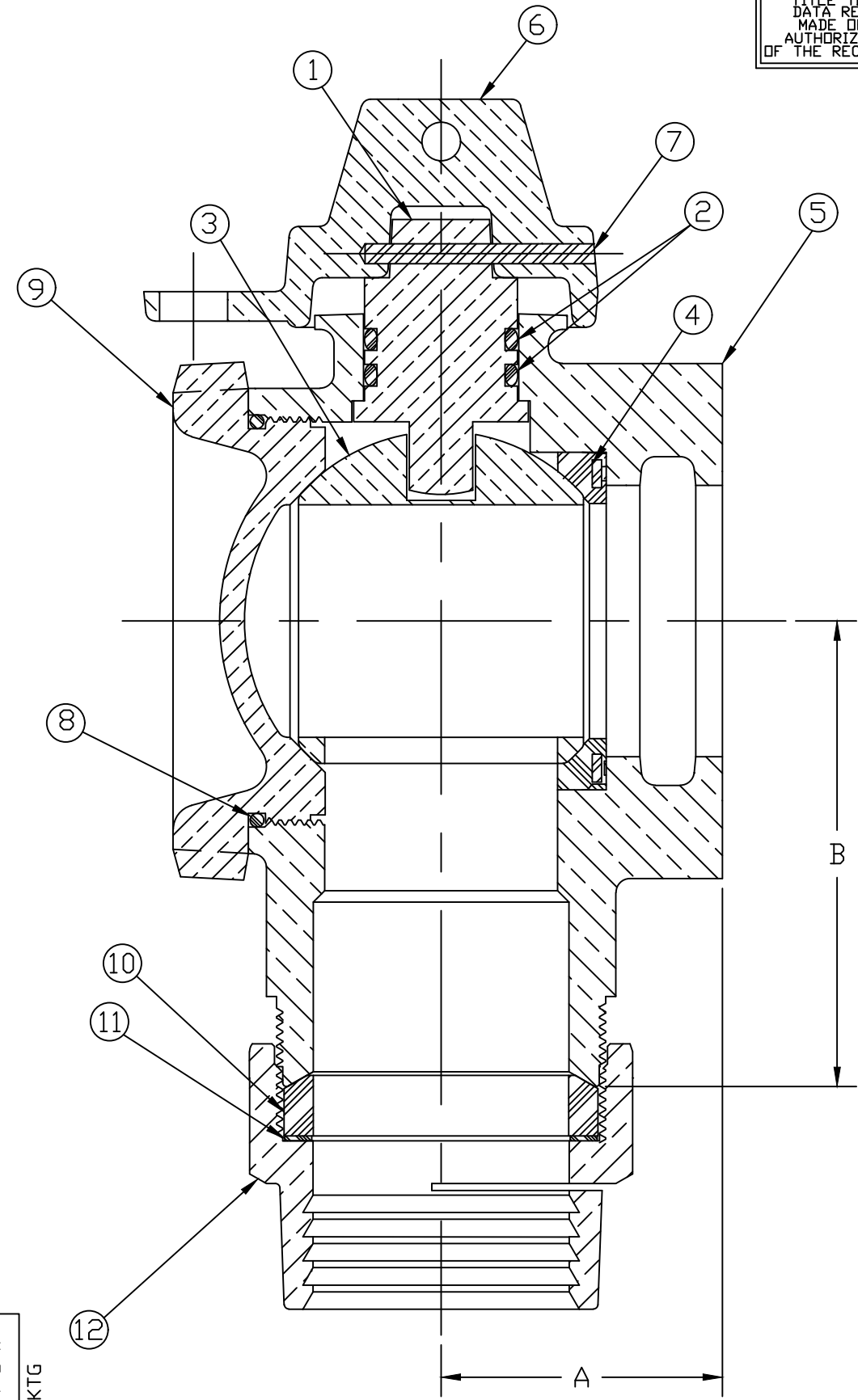

No.	DESCRIPTION	MATERIAL
1	STEM	CAST LOW LEAD BRASS ALLOY
2	O-RING	EPDM ASTM D2000
3	BALL	CAST LOW LEAD BRASS ALLOY
4	GASKET - SEAL	NITRILE ASTM D2000
5	BODY	CAST LOW LEAD BRASS ALLOY
6	CAP	CAST BRASS ASTM B62 ALLOY C83600
7	ROLLPIN	STAINLESS STEEL ASTM A240 TYPE 302
8	O-RING	EPDM ASTM D2000
9	SEALING PLUG	CAST LOW LEAD BRASS ALLOY
10	PJ GASKET	EPDM
11	PJ WASHER	POLYPROPYLENE
12	CLPG NUT SUB	CAST BRASS ASTM B62 ALLOY C83600

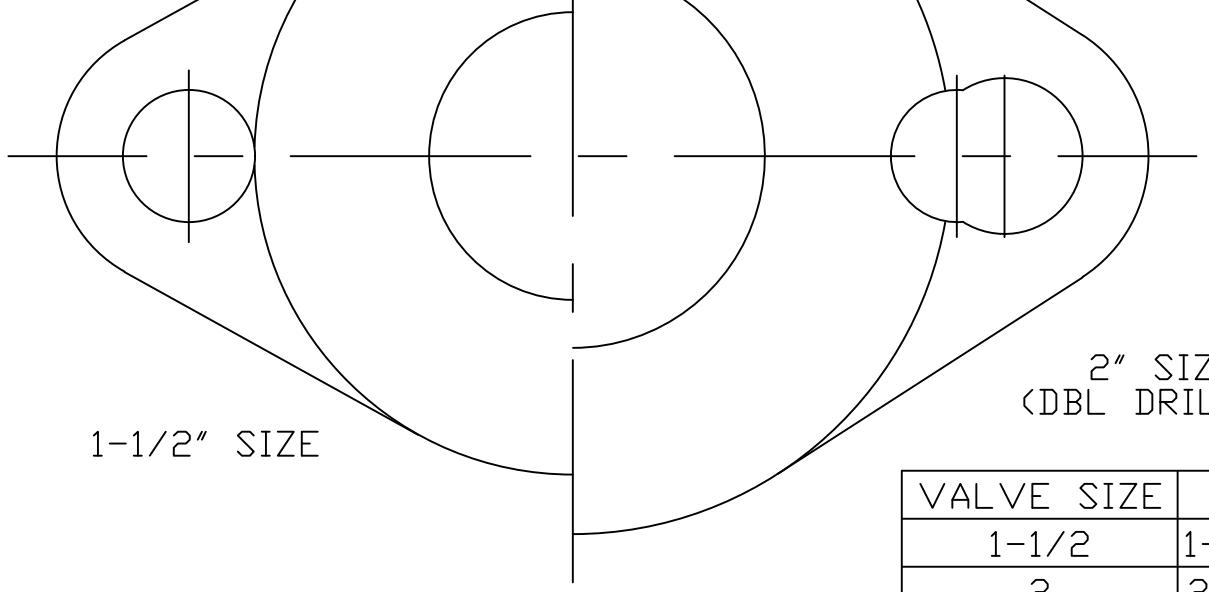

VALVE SIZE	A	B
1-1/2	1-13/16"	3"
2	2-3/16"	3-25/32"

ALL WETTED PARTS ARE LOW LEAD BRASS ALLOY

FILEPATH: PROD-ENG\JJ\SUBMITTALS\E1975W

						DRFTR	RWB	6/9/08	JONES	UNLESS OTHERWISE NOTED THIRD ANGLE PROJECTION SURFACE PREPARATION: BREAK CORNER(S) ---- .000 SURFACE FINISH -- XX RMS TOLERANCE(S): LINEAR ----- ± .000 ANGULAR ----- ± 0°00'	REF. No.	SCALE
						CHKR						
						ENGR						
						MGR						
								BY	DATE			
								STK No:				
								MAT'L:				
								DESCR.	BALL ANGLE LLB METER VALVE LESS STOP 360° CAP (PJ CTS x MTR FLANGE)		DWG NUMBER E1975W	
REV	ECR	DESCRIPTION	DATE	BY	CHKR							

DWG NUMBER
E1975W
JJ-MRKTG